



ASSEMBLY INSTRUCTIONS

Photo Real Scale Building Kit by **INNOVATIVE**
HOBBY SUPPLY

**Clark's
Steel
Factory**

READ ALL STEP BY STEP INSTRUCTIONS

- A new alternative to plastic form scale building models!
- Photo Real Scale Building kits may be the most realistic kits available!
- Great for use on model dioramas, slot car, and train track layouts!
- Designed using real building elements for the most realistic appearance



Footprint Dimensions

Model Base
8" x 11"

Clark's Steel
Factory 5" x 9"

All scale building kits offer many optional features, for a variety of creative ways to complete each project!

Free replacement parts are available call: 866-712-4059



Cut out all components and place in a safe area and place all parts in a tray so you do not lose any.



STEP 1 - Collect the correct tools.

For best results, we suggest you gather at least the most basic tools you will need to complete assembly. While you may find more tools that will help you achieve outstanding results, we suggest you start with the following: Hot glue gun, scissors, variety of water based colored markers, tweezers, straight edge rulers, hobby knife, instant setting high strength hobby glue Plus 4ea, Hot Glue Sticks



STEP 3 - With appropriate color markers, detail the edges of all the parts you cut out. This will result in a finely finished project once assembled.

STEP 2 - Empty contents of the kit, carefully cut out all the individual parts to be assembled with a Scissors. The most precise cuts you can make will result in a dramatically better looking finished project. Use smooth long scissor strokes on the bigger parts.

STEP 4 - **Scoring.** Using a Hobby Knife (see picture) and a straight-edge ruler, apply lighter Blade pressure onto the marked fold line on the part you wish to fold. Scoring along these lines to be bent makes bending all printed parts easier, and results in a much cleaner looking fold. Bend parts using the length of your straightedge ruler or a desk edge
Scoring is an essential skill. Practice on Scrap piece.



TIP: Look Ahead At All Photos For Extra Guidance



STEP 5 - With scale building kits, there is usually no correct place to begin. In this case, we'll start by prepping the front wall and back wall. Score and fold the side glue tabs with a ruler and a hobby knife. Fold tabs inwards, like shown above.

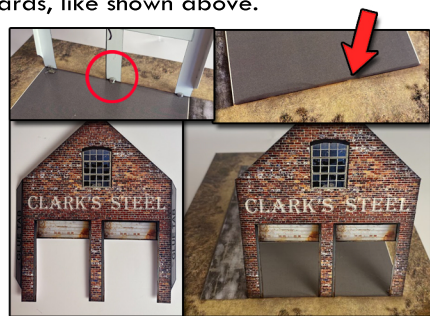

STEP 8 - After the garage doors are assembled, grab the base. The textured part on the gray base is the side the front wall belongs to. But, before gluing it to the base, get a watercolor marker that matches the ashy ground. Lightly color the white line that is on the same side the front wall belongs to. You want to blend the color with the ground. Use a finger to help blend the color in the white line. Then glue the front wall on to the base evenly. Place a small amount of hot glue behind the front wall to secure it to the base. Avoid placing too much hot glue on the outer back sides of the front wall. As it will become hard to secure the side walls if there is too much glue. Hold until dry.

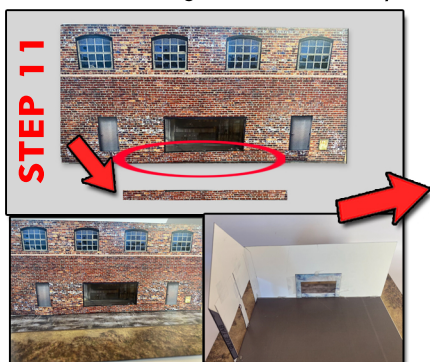

STEP 11 - Next, flip the left side wall on to the front side. And grab the add on window bottom wall. Place it right below the window, align it with the bottom of the wall and the two side doors. Once it is lined up evenly, use a small amount of white or hot glue to secure it on to the left side wall. Then connect the left side wall on to the front wall by using the front wall's glue tab. The left side wall belongs to the side of the side with the porch. Place evenly, then place a small amount of white glue behind the wall. Hold until dry.



STEP 6 - This step is optional. If you want to use the garage illusion room continue reading step 6. You can either have one garage door open or both. Avoid cutting the garage door trims. Grab a pair of scissors, cut by starting from the bottom of the inside of the garage door up until you hit the top of the garage door trim. Cut slits on both sides of each garage doors. Then use a hobby knife and a ruler, cut the top of the garage door so the whole door comes out nicely. Follow the red dotted line and blue solid line to see where to cut.



STEP 9 - Now grab the left side wall. Grab a pair of scissors, cut by starting from the bottom of the inside of the window up until you hit the top of the window trim. Avoid cutting the garage door trims. Cut slits on both sides of window. Then use a hobby knife and a ruler, cut the top of the window, so the whole door comes out nicely.

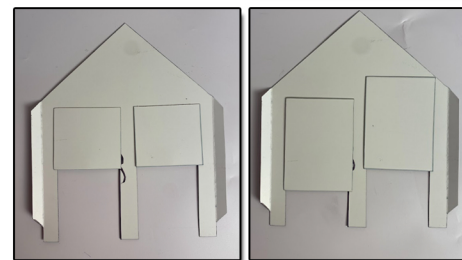

Step 7 - Next, flip the front wall to the white side. Then flip the extra garage doors, so the white side is also facing you. You can either cut the garage doors so they look more open on the other side, or you can leave them just as they are and make them slightly open. After you decide how you want your garage doors to look, place tape on top of the back of the garage doors and the front wall to secure. Adjust if needed.

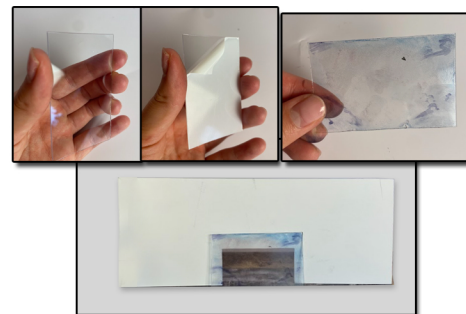

Step 10 - After cutting out the window, grab the glass that is included with the kit. Carefully take off the white wrapper on both sides. Then this part is optional, get some watercolor markers, like dark blue, brown, and gray. Color smudges and details on to the window to make it appear old. Have fun with it. Then place the glass behind the back of the left wall, making sure the open section is covered completely. Use tape to secure.

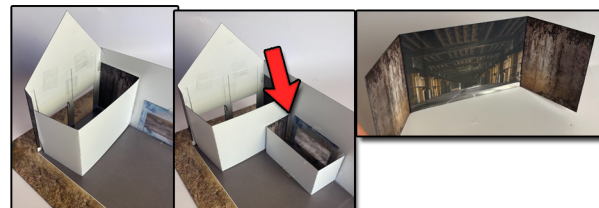

STEP 12 - Moving forward, grab the two illusion rooms. Score the side white lines on them. Then fold the sides inward 90 degrees from the middle wall. Next place the garage illusion room directly behind the doors like shown above. Use hot glue to secure. After place the window illusion room behind the window. Use hot glue to secure.



STEP 13- Now let's glue the rest of the walls on to the building. Grab the right side wall and connect it to the front wall by using the front walls glue tab. Use hot or white glue. Once the right wall is glued to the front walls tab, place a small amount of hot glue between the bottom and top back side corners of the walls to connect them seamlessly together. Then place small amounts of hot glue behind the right side wall when lined up with eh base evenly.

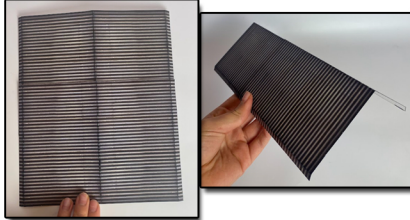

STEP 16 - On to the next step, let's score and fold the main roof. Fold the two big sides slightly downwards, then fold the side small tabs along the outside of the roof fold downwards, like shown above. Place the main roof on top of the building. Use hot glue to secure the roof on to the building if you want it to stay on permanently Place small amounts of hot glue along the tops of the front and back wall then carefully place the roof on top evenly. Hold until dry.



STEP 19 - Grab the optional metal drums, the bigger piece, roll with a pencil to round the paper. Use hot glue to connect each end into a little cup. Then grab the circle top and score it on to the cup to create a metal drum. Next round the stack of pipes, glue the sides on to the rounded stack of pipes. Place anywhere.



STEP 14- Next, apply the back wall to the rest of the building, use white or hot glue. Use the same technique when gluing the rest of the building together. After the buildings walls are together, let's start assembling the adds on like the optional 3D dumpster. Score the white lines, and fold the sides into a box. Fold the top downwards, like shown above. Place anywhere after making. I put mine against the back wall.



STEP 17- For the other roof we also want to score the white line, then fold the small tab shown above slightly angled. And the glue tab downward. After, find the white-ish line on the left side wall near the windows. Use white or hot glue and the glue tab to secure the side porch roof on to the white line. Hold until dry.



STEP 20 - Score and fold the white line on the sign. Fold both sides downward on to each other, glue together. Place on top of the roof with hot glue, hold until dry. Then grab the short and long smoke stacks, color the inside white part of the stacks black. Then score the white lines, fold the sides into a box, use hot glue to secure together. Then place them anywhere on the steel factory.

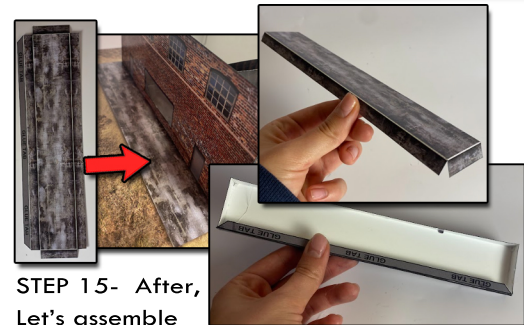

STEP 15- After, Let's assemble the side porch. Score the white lines, and fold it into a box. Fold the glue tab inwards on the bottom, like shown above, so it is parallel to the ground when gluing. Use hot glue to connect the sides. Place the finished product on to the base that has the same art as the porch. Use white or hot glue to secure the base evenly. I recommend placing a small amount of glue on to the side of the porch so it is also secure against the left side wall.



STEP 18- Now grab the stick that included in the kit and the support beam ruler. Mark the stick that is included in the kit the same height as the red ruler. Cut out two pieces of stick that are the same height. After use a brown marker to lightly color the sticks for more realism. Then place the stick underneath the side porch roof and on top of the porch. Use hot glue to secure. You want to pace each stick on each end of the porch for support.



STEP 21 - Lastly, score the porch ramp, use the small tab to help connect the ramp anywhere on the porch, use hot glue. Place barrels and signs anywhere you would like on the steel factory.

**GO TO LAST
PAGE FOR RESULTS**



ASSEMBLY INSTRUCTIONS

Photo Real Scale Building Kit by

INNOVATIVE
HOBBY SUPPLY

**Clark's
Steel
Factory**



Front of Building



Left Side of Building

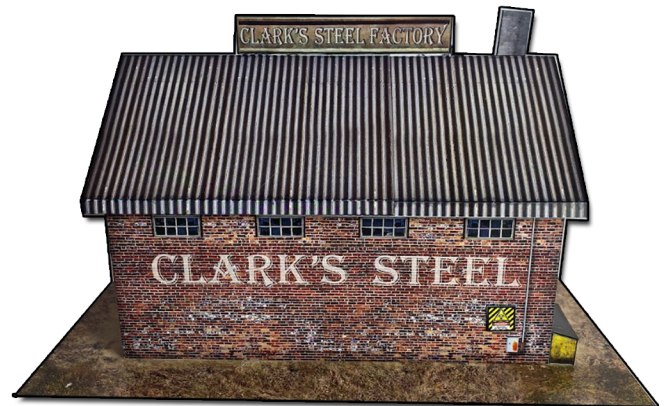

Right Side of Building



Rear of Building