



ASSEMBLY INSTRUCTIONS

Photo Real Scale Building Kit by **INNOVATIVE**
HOBBY SUPPLY

**24 Hour
Motel**

READ ALL STEP BY STEP INSTRUCTIONS

- A new alternative to plastic form scale building models!
- Photo Real Scale Building kits may be the most realistic kits available!
- Great for use on model dioramas, slot car, and train track layouts!
- Designed using real building elements for the most realistic appearance



Footprint Dimensions

Model Base
8" x 11"
24 Hour Motel
Foundation 5" x 9"

All scale building kits offer many optional features, for a variety of creative ways to complete each project!

Free replacement parts are available call: 866-712-4059



STEP 1 - Collect the correct tools.

For best results, we suggest you gather at least the most basic tools you will need to complete assembly. While you may find more tools that will help you achieve outstanding results, we suggest you start with the following: Hot glue gun, scissors, variety of water based colored markers, tweezers, straight edge rulers, hobby knife, instant setting high strength hobby glue Plus 4ea, Hot Glue Sticks

Cut out all components and place in a safe area and place all parts in a tray so you do not lose any.

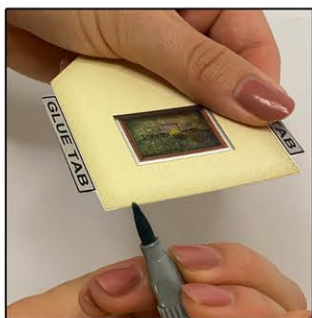

STEP 3 - With appropriate color markers, detail the edges of all the parts you cut out. This will result in a finely finished project once assembled.

STEP 2 - Empty contents of the kit, carefully cut out all the individual parts to be assembled with a Scissors. The most precise cuts you can make will result in a dramatically better looking finished project. Use smooth long scissor strokes on the bigger parts.

STEP 4 - **Scoring.** Using a Hobby Knife (see picture) and a straight-edge ruler, apply lighter Blade pressure onto the marked fold line on the part you wish to fold. Scoring along these lines to be bent makes bending all printed parts easier, and results in a much cleaner looking fold. Bend parts using the length of your straightedge ruler or a desk edge
Scoring is an essential skill. Practice on Scrap piece.

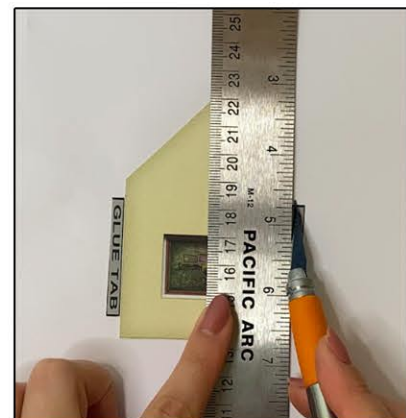

TIP: Look Ahead At All Photos For Extra Guidance

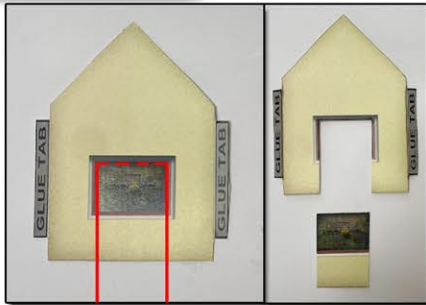

STEP 5 - With scale building kits, there is usually no correct place to begin. In this case, we'll start by prepping the side wall. Using scissors, start by lining up the scissors from the bottom of the wall to the inside of the window. Cut up while avoiding to cut the window frames. Stop cutting up once your about to hit the top of the window frame. After making a slit on one side, repeat this step to the other side of the window. Look at the red solid lines above as a guide. Then once you have two slits on both sides, use a hobby knife and straight edge to cut the inside top of the window. Use the red dotted line as a guide.

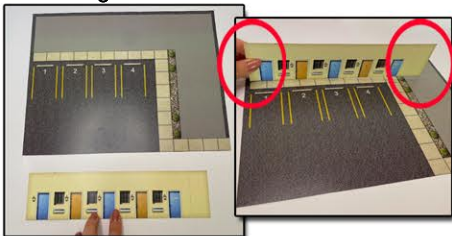

STEP 8 - Next let's apply the front motel wall on to the base. Make sure it is the correct wall. The door numbers should match with the numbers on the parking lots. Place evenly on to the base, lining up with the gray base and front sidewalk. No gray from the base should show in front of the wall. Before gluing just know the front wall is suppose to go over the base on the right side. Use small globs of hot glue behind the wall to secure it against the base. Hold 90 degrees up from base until completely dry.



STEP 11 - Next grab the right side back wall. Score and fold the glue tab. Make sure your gluing the right side back wall right behind the right front wall. Use the side walls glue tab to secure the right side back wall. Use white or hot glue. Hold until dry. Then place small amounts of hot glue behind the wall to secure it to the base.

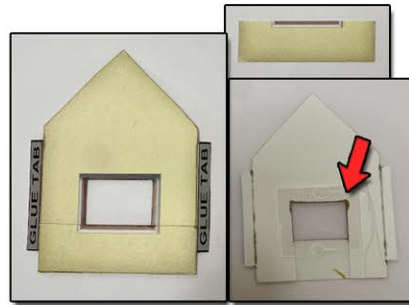

STEP 6 - Once the inside part of the window is taken out, repeat for the other side wall. Then grab both of the bottom add on side walls. Place one on top of the side walls. Line up the small wall with the original window frame, like shown above. Use white glue to secure the walls together. After, flip over the wall so the white side is facing you. Grab the two pieces of glass that is included in the kit, and carefully take both sides of the plastic wrapper off. Place the piece of glass on top of the open section. Once the glass is covering the whole window section and is even, secure with tape or glue. Make sure the tape or glue is not visible from the front.

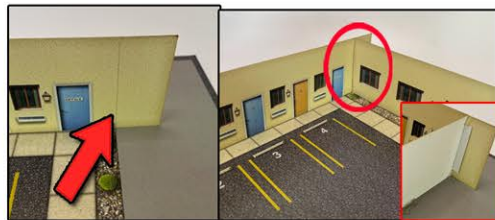

STEP 9- Use the line on the front wall as a guide to see where to glue the right side front wall. Score and fold the glue tab on the right side front wall. Fold it 90 degrees away from the wall. Use the glue tab to secure it to the front wall. Use white or hot glue. After its connected to the front wall, line up the right front wall to the base evenly. Then use small globs of hot glue behind it to secure the wall to the base.

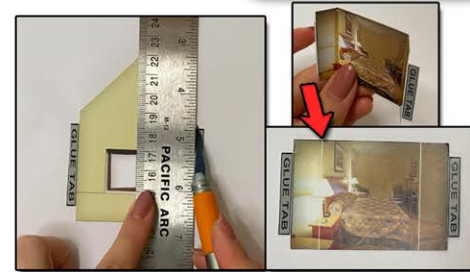

Step 7 - Next score and fold the side walls glue tabs. Then put the side walls on the side for later. After grab both of the illusion rooms. Score the white lines on the sides and the glue tabs. Fold the sides slightly inwards. And fold the side glue tabs away from the front, like shown above.

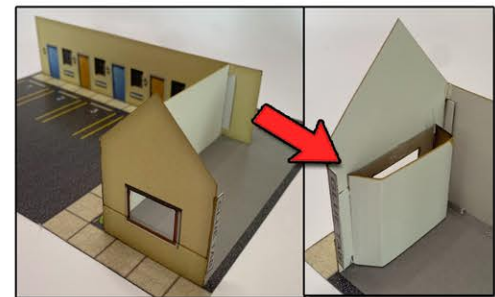

Step 10 - After let's glue one of the side walls to the right front side wall. Use the glue tab to secure it to the wall evenly. Then carefully place a small glob of hot glue behind the middle of the side wall. Let dry. Next grab one of the side wall illusion rooms and glue directly behind the walls window, like shown above. Secure with hot glue.



STEP 12 - Then grab the back wall, use the right back wall's glue tab to secure the back wall on to the building. After place hot glue behind the back wall. Finally glue the other side wall on to the rest of the building. Place the illusion room back of the side wall window.

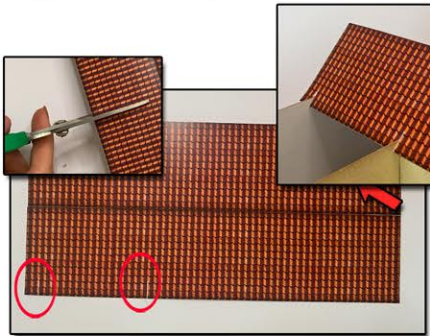

STEP 14 - Now let's prep the roofs. Grab the right side roof. In the photo it's hard to see the small white lines. But in the red circled areas are where the white line are located. Using scissors cut where the white lines are to create two small slits. This is where the motels walls will be locked in between. After score the middle white line. Fold downward. Apply on the right side of the building.

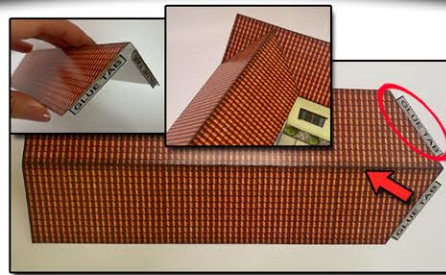

STEP 15 - Then grab the left side roof. Score the glue tabs and fold them downward like shown above. Use the glue tabs to secure the left roof on to the right roof. Score the white middle line on the roof, and fold. You can also place a small amount of hot glue underneath the other side of the roof to really secure it to the roof. Place evenly. **WHERE TO SCORE AND FOLD**

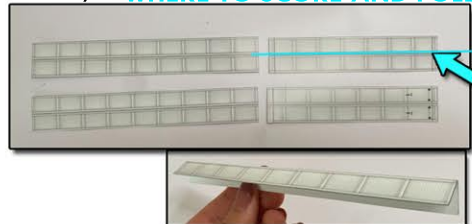

STEP 18 - Once the second base is on, let's assemble the pool's fence. Grab all the fence and score the white line between them. After the middle is scored, fold the top fence downwards. So both sides are fence. Then between the folded fence place a small amount of hot glue. Immediately place a heavy book or flat object on top of it to hold it down, so it dries flat.



STEP 21 - The last few steps will be just assembling the add ons, like this roof sign. Score the white lines and fold into a box then glue together. Use the sides to place anywhere on top of the roof. Secure with hot glue. There is also a street sign you can use. Score and fold, then glue. Use the black circle on the bottom tab to see where to glue the black straw that's included in the kit. Cut the straw to any length you want. Place anywhere on the base.

Both signs are optional.

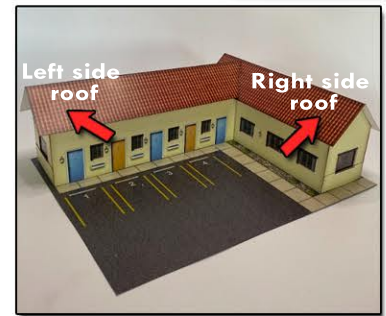

STEP 16 - After the whole motel is assembled and together, it should look like something above. The picture shows you where the right and left side roofs are.

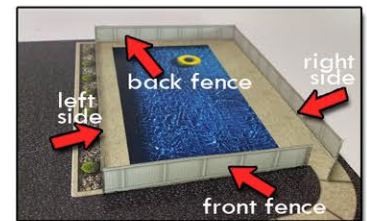

STEP 19 - Glue the fence together into the correct spot. I recommend using hot glue. Apply a small thing of hot glue below the fence and apply on the second base around the concrete. For the front fence you cut cut where the fence opens and glue the door to the right side to look more realistic.



STEP 22 - For the last step, grab the ice and pop machine. Score and fold then glue using hot glue. Place machines against the right side front wall between the windows, like shown above. And your done.



STEP 17 - Next grab the second base with the pool. Overlap the second base with the other base located right by the other rooms labeled 5 through 8 doors. You can either connect the two bases with white or hot glue, or simply just leaving it. If you do not glue it, it will be easy to put aside when not wanted.

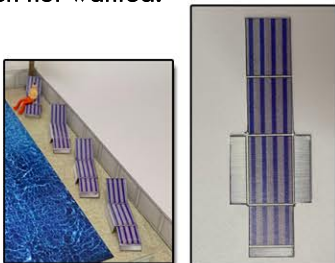

STEP 20 - Now score all the white lines on the optional pool lawn chairs. Fold the sliver legs downward, and the top tab up. Copy where to fold on the photo above. Repeat this step for all of the chairs. And place by the pool.

**Look at the next
page to see the
final results**



ASSEMBLY INSTRUCTIONS

Photo Real Scale Building Kit by

INNOVATIVE
HOBBY SUPPLY

**24 Hour
Motel**



Front of Building



Left Side of Building



Right Side of Building



Rear of Building