



# ASSEMBLY INSTRUCTIONS

Photo Real Scale Building Kit by **INNOVATIVE**  
HOBBY SUPPLY

**Western  
Diorama**

## READ ALL STEP BY STEP INSTRUCTIONS

- A new alternative to plastic form scale building models!
- Photo Real Scale Building kits may be the most realistic kits available!
- Great for use on model dioramas, slot car, and train track layouts!
- Designed using real building elements for the most realistic appearance



## Footprint Dimensions

Model Base  
8" x 11"

For both 1/25 and  
1/64 scales

*All scale building kits offer many optional features, for a variety of creative ways to complete each project!*

Free replacement parts are available  
call: 866-712-4059



**Cut out all components and place in a safe area and place all parts in a tray so you do not lose any.**



## STEP 1 - Collect the correct tools.

For best results, we suggest you gather at least the most basic tools you will need to complete assembly. While you may find more tools that will help you achieve outstanding results, we suggest you start with the following: Hot glue gun, scissors, variety of water based colored markers, tweezers, straight edge rulers, hobby knife, instant setting high strength hobby glue Plus 4ea, Hot Glue Sticks



STEP 3 - With appropriate color markers, detail the edges of all the parts you cut out. This will result in a finely finished project once assembled.

STEP 2 - Empty contents of the kit, carefully cut out all the individual parts to be assembled with a Scissors. The most precise cuts you can make will result in a dramatically better looking finished project. Use smooth long scissor strokes on the bigger parts.

STEP 4 - **Scoring.** Using a Hobby Knife (see picture) and a straight-edge ruler, apply lighter Blade pressure onto the marked fold line on the part you wish to fold. Scoring along these lines to be bent makes bending all printed parts easier, and results in a much cleaner looking fold. Bend parts using the length of your straightedge ruler or a desk edge  
Scoring is an essential skill. Practice on Scrap piece.

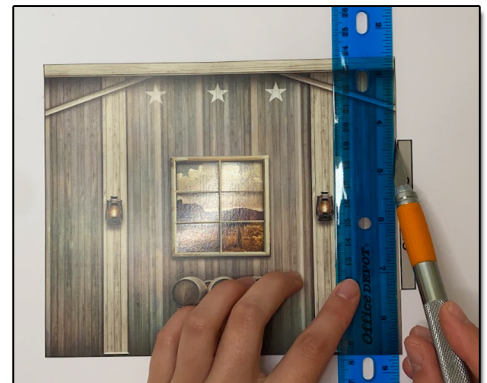



**TIP: Look Ahead At All Photos For Extra Guidance**



**STEP 5** - With scale building kits, there is usually no correct place to begin. In this case, we'll start by prepping the walls. Grab the right, left, and main inside and outside walls, including all the add ons.

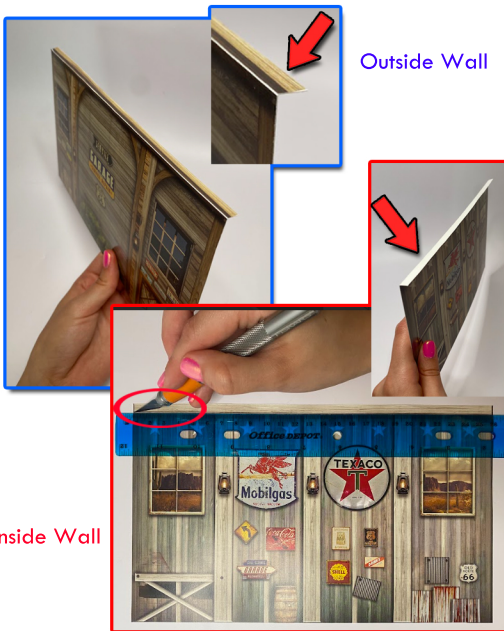

**STEP 8** - Once you score on the Main Outside Wall, fold the top part you scored away from you. It should look like the blue outlined picture shown above. Next score the bottom of the trim on the Main inside Wall. Fold the trim TOWARDS you so the white side is facing up, like shown above in red.



**STEP 6** - As an example, let's assemble the add on stacked barrels. Find the original art for the stacked barrels on the left inside wall. Place small globs of hot glue on to the original art of barrels and let dry. Then grab the add on stacked barrels, flip so the white side is facing you. Next place a small amount of hot glue on the white side, like shown above. Then place the add on on to the original art while lining it up evenly. As you can see from the example above, applying the add on gave the diorama a realistic touch. Continue to apply the add ons to the dioramas walls.

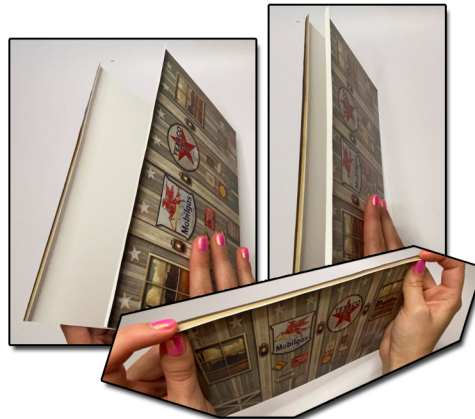

**STEP 9**- After both the main inside and outside walls are scored and folded, they should interlock with each other on the top when putting them together like shown above. But before we glue them together, let's prep the side walls. Repeat step 7 and 8 for the left/right inside and outside walls. Once they are done put all the Outside walls aside.

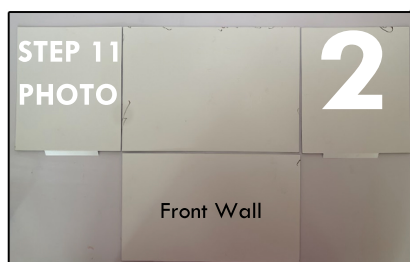

**Step 7** - As a side note **\*THE NEXT FEW STEPS ONLY APPLIES TO THE 1/25 SCALE DIORAMAS\*** If you aren't assembling a 1/25 scale go to step 10 to continue. Let's finish prepping the Main Outside and Inside walls. Put them next to each other so they are touching like shown above. Next grab a ruler and put it directly underneath where the bottom of the Main inside wall trim is (where the blue dotted line is above). Once you find where the bottom of the trim is on the Inside Wall, slide the ruler carefully on to the Main Outside wall. The width from the top of the wall to the bottom of the trim part on the inside wall is the same width you want to score on the Main Outside wall.



**Step 10** - Grab the both the right and left inside walls. Score the glue tabs and fold them inwards 90 degrees from the wall like shown above.

**STEP 11** - Next, grab all of the inside walls. Place the main wall on top, and the base below it. **\*The tool box should be facing on the upper left side on the base.** Then place the left wall aligned with the left side of the base like shown in 1. Same thing goes for the right wall. The ends of the walls need to be touching the bases sides while laying flat. After, Flip everything so the white side is facing you. Make sure when it's upside down it still looks like Version 1 but facing downwards. Check if the art side is facing the correct way before moving on to the next step. For clarification, you have to move/- adjust the side walls, base, and the main, so it looks like Version 1 upside down. **Side note\*** The glue tabs should be closer towards the Main wall.



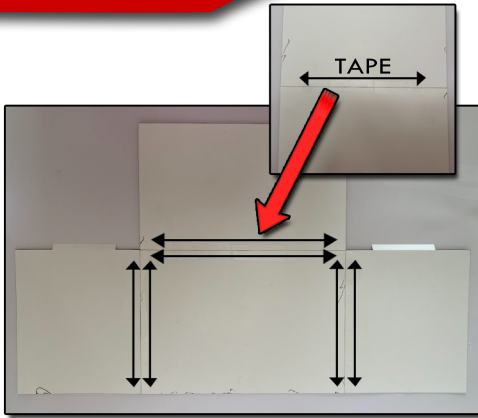

**STEP 12** - After the inside walls are flipped correctly, place scotch tape along both the bottom of the walls and the base together. When placing the tape on, hold whichever wall your taping to the base as close as you can, so the cracks are invisible from the other side.



**STEP 15** - Now that the side walls are secured to the main wall, it should look something like this. The next step is to secure the outside walls on to the back of the inside walls. For this step it does not matter which outside wall you glue first.

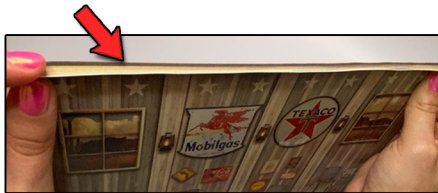

**STEP 18** - Repeat step 16-17 for all the outside walls. Once the outside walls are secure to the back of the inside walls, the next step is only for the 1/25 scale dioramas. If you are assembling a 1/64 scale, you are finished assembling! Going back to step 9, we had to score and fold the walls trims. This step we will be gluing them together. Place a small amount of white or hot glue between the two folded trims. (the white sides) Then pinch them together until dry. Repeat this step for all the walls.

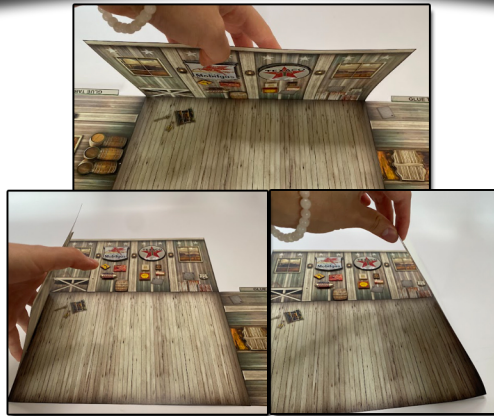

**STEP 13** - Next flip the whole thing back to front side carefully, bend the walls inward carefully like shown above. This will help the walls become more flexible with the scotch tape behind it.

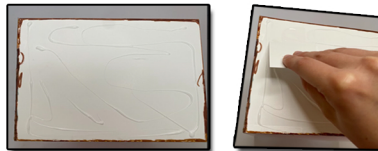

**STEP 16** - As an example, I will be gluing the main outside wall on to the back of the main inside wall. Flip the diorama carefully to the back of the main inside wall so the white side is facing you. Grab a marker that matches the buildings walls, I used a brown marker for this diorama. Carefully color the edges around the back side, like shown above. Its okay if it looks a little messy on the back, because it will be covered later on. This part is optional, coloring around the edges prevents the white from showing on the sides when gluing the outside walls on top. Next place a small amount of white glue around the white side of the wall. Then use a scrap piece of paper or something that has a flat surface you can throw away later, use the scrap piece of paper to drag the white glue evenly on the wall. This will help grab extra glue that is not needed.



**STEP 19** - After the trims are secured together, grab the one of the flat popsicle sticks, included in the kit. Place it on the bottom of the folded trim on the main inside wall, place it to a fartherst corner. Glue it underneath the folded trim with hot glue. Then grab the second stick and place is underneath next to the other one. Before gluing on to the bottom of the trim, cut the popsicle stick to the perfect size to fit the rest of the main walls width. Then glue.

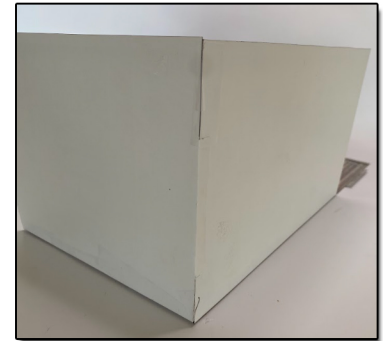

**STEP 14** - Then bring the Main wall inward 90 degrees up, including one of the side walls. Fold the glue tab on the side wall 90 degrees towards the back of the main wall. Place a piece of tape on to the glue tab and stick it to the back side of the main wall to hold together. When taping the walls together make sure they are close to each other. If the top and bottom corners are not together completely, place a small amount of hot glue behind the corners while holding the two walls nicely together until the gap is sealed tightly. Repeat step 14 for both side walls.

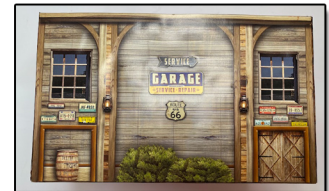

**STEP 17** - Once the glue is spread on nicely place the main outside wall on top evenly, adjust before the glue dries. To hold the walls together, flip the diorama so the inside part is facing you. Place something heavy like a book or some cans on top of the main wall until the glue is dried completely. You will only need to place something heavy on top if you are assembling a 1/25 scale. For the smaller scales it won't be necessary.



**STEP 20** - Then color the white sored line from the back. And color any white showing from the inside. After your done it should look like the imagine above.



# ASSEMBLY INSTRUCTIONS

*Photo Real Scale Building Kit by*

**INNOVATIVE**  
HOBBY SUPPLY

**Western  
Diorama**



Front of Building



Left Side of Building



Right Side of Building

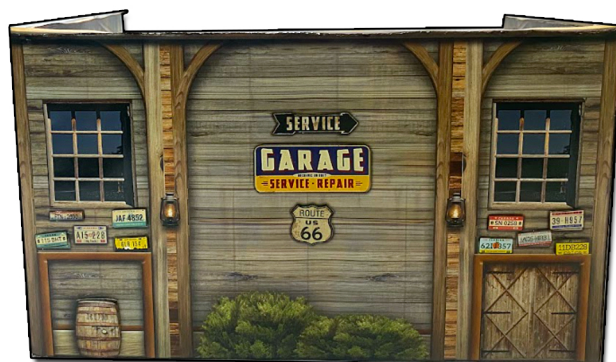

Rear of Building