



ASSEMBLY INSTRUCTIONS

Photo Real Scale Building Kit by **INNOVATIVE**
HOBBY SUPPLY

**Convenience
Store and
Coffee Shop**

READ ALL STEP BY STEP INSTRUCTIONS

- A new alternative to plastic form scale building models!
- Photo Real Scale Building kits may be the most realistic kits available!
- Great for use on model dioramas, slot car, and train track layouts!
- Designed using real building elements for the most realistic appearance



Footprint Dimensions

Model Base
8" x 11"

Convenience Store and
Coffee Shop

*All scale building kits
offer many optional
features, for a variety
of creative ways to
complete each project!*

Free replacement
parts are available
call: 866-712-4059



Cut out all components and place in a safe area and place all parts in a tray so you do not lose any.

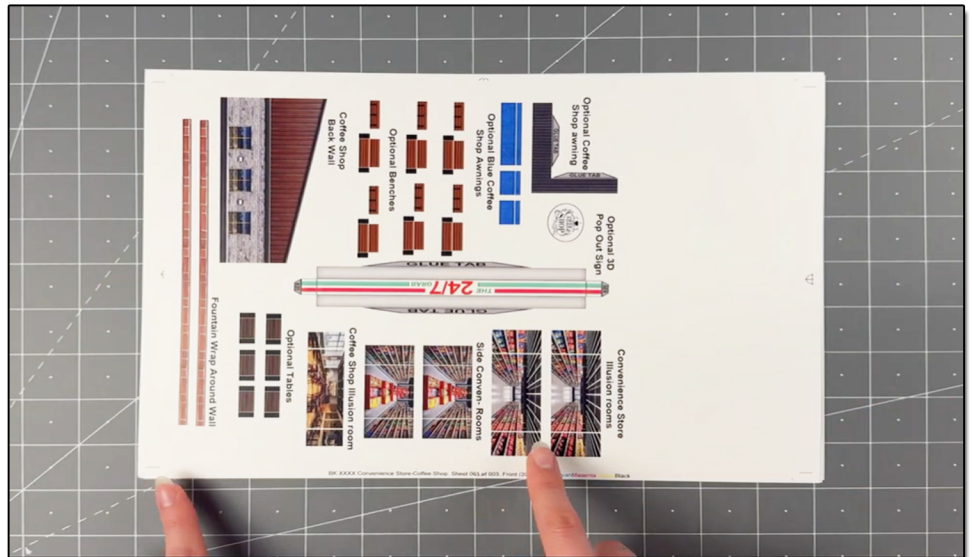

STEP 1 - Collect the correct tools.

For best results, we suggest you gather at least the most basic tools you will need to complete assembly. While you may find more tools that will help you achieve outstanding results, we suggest you start with the following: Hot glue gun, scissors, variety of water based colored markers, tweezers, straight edge rulers, hobby knife, instant setting high strength hobby glue Plus 4ea, Hot Glue Sticks

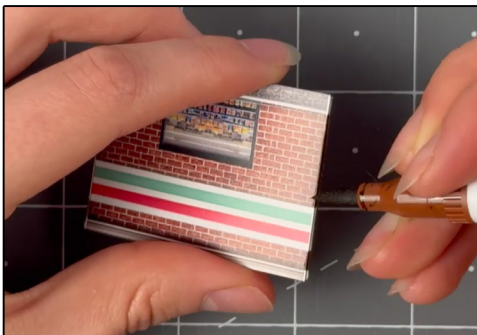

STEP 3 - With appropriate color markers, detail the edges of all the parts you cut out. This will result in a finely finished project once assembled.

STEP 2 - Empty contents of the kit, carefully cut out all the individual parts to be assembled with a Scissors. The most precise cuts you can make will result in a dramatically better looking finished project. Use smooth long scissor strokes on the bigger parts.

STEP 4 - **Scoring.** Using a Hobby Knife (see picture) and a straight-edge ruler, apply lighter Blade pressure onto the marked fold line on the part you wish to fold. Scoring along these lines to be bent makes bending all printed parts easier, and results in a much cleaner looking fold. Bend parts using the length of your straightedge ruler or a desk edge
Scoring is an essential skill. Practice on Scrap piece.



TIP: Look Ahead At All Photos For Extra Guidance

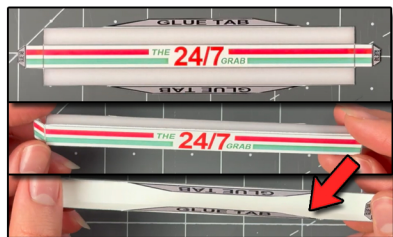

STEP 5 - With scale building kits, there is usually no correct place to begin. In this case, we'll start by prepping the 3D optional pop out sign. Score all the top, bottom, and all the glue tabs with a hobby knife and ruler. Fold the sides inwards together to create a cuboid. Touch up the scored seams with a watercolor marker.

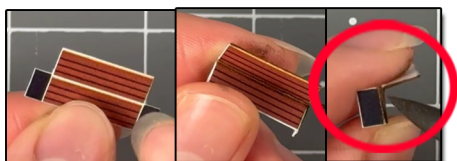

STEP 8 - Then grab the optional benches and score all the white lines with a hobby knife and ruler. Fold the top part towards you 90 degrees upwards. And the black tabs downwards. Touch the scored seams with a corresponding watercolor marker.

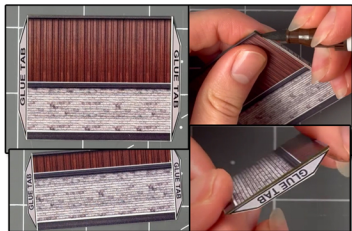

Step 11 - Grab the coffee shop side walls and score the glue tabs. Fold the tabs inwards. Touch up the scored seams with a brown watercolor marker.



STEP 13 - Next, grab the coffee shop front wall and remove the inside part of the windows, following the same steps in step 10. Cut one piece of window material for the window open sections. Place window material on top. Making sure to remove the wrapper on both sides. Then taping. Put aside for later.

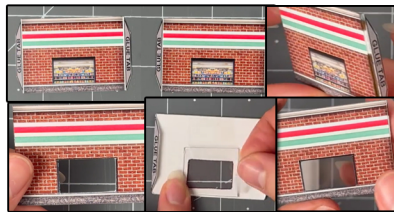

STEP 6 - Grab the side convenience store walls and score the glue tabs. Fold the tabs inwards. And touch up the seams with a watercolor marker. Cut the inside part of the windows avoiding cutting the frames and walls at all times, using a hobby knife and ruler. Once done, flip over so the white side is facing you. Touch up the cut edges with a marker. Then grab the window material included in the kit, and cut two pieces that slightly overlap the open window sections, unwrap both sides until see through. Place on top, and secure with tape.

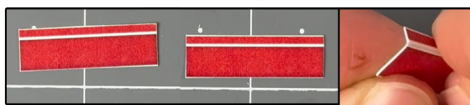

STEP 9 - On to the next step, grab the optional red awnings. Score the small tab with a hobby knife and ruler. Fold inwards. Touch up with a red marker. Put aside for later.

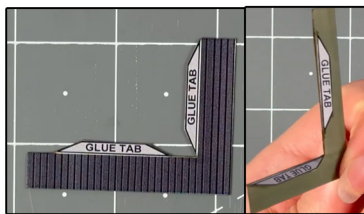

STEP 12 - After, grab the optional coffee shop awning and score the two glue tabs. Fold downwards. And touch up the seams with a dark marker. Put aside for later.



STEP 14- After grab the front convenience store wall and place it evenly on the front of the correct base. Line up with the white line on the base, place small amounts of hot glue behind the wall to secure against the base.

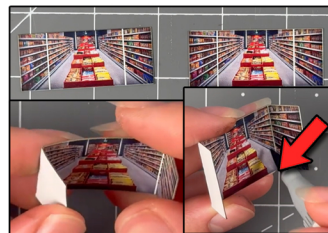

Step 7 - Now let's prep the illusion rooms. For all of them gently score the two white lines with a hobby knife and ruler, fold the tabs outwards towards you, and touch up the seams with a gray or brown marker. Put aside for later.



Step 10 - Next, let's open the two front windows on the front wall. Cut the inside part of the windows avoiding cutting the frames and walls at all times, using a hobby knife and ruler. Once done, flip over so the white side is facing you. Touch up the cut edges with a marker. Then grab the window material included in the kit, and cut two pieces that slightly overlap the open window sections, unwrap both sides until overlap the open window sections, unwrap both sides until see through. Place on top, and secure with tape.



STEP 15- Connect the side walls on to the front wall using the glue tabs. Place hot glue behind, hold until dry. Then glue the back wall on. Glue on side at a time to avoid unevenness. For the front wall place the optional red awnings above the windows. Then place the correct illusion rooms behind the window sections. Use hot glue to secure.



STEP 16- Then grab pop out sign and place it on to the original art evenly, securing by using the glue tabs and hot glue. Or use a white glue. After place the roof evenly on top.

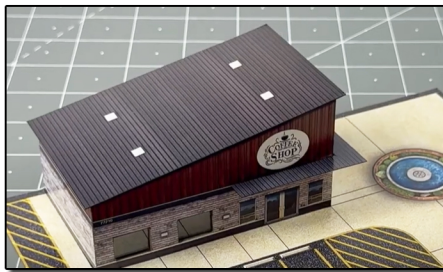

STEP 19- Place the the roof on top! Glue the 2D add on sign on tot he original art.



STEP 21- Then grab a piece of saran wrap in your kitchen! Something around 3 X 3 inches. After pinch the middle of the wrap. Then with your other hand carefully loop it through the pinch section to the other end. Cut how tall you want the water fountain to be. Create water details with a pair of scissors. Cut the tip off a little to create a flat surface so it can glue on to the base nicely. Place hot glue in the middle of the fountain and place on top. Hold upwards until dry.

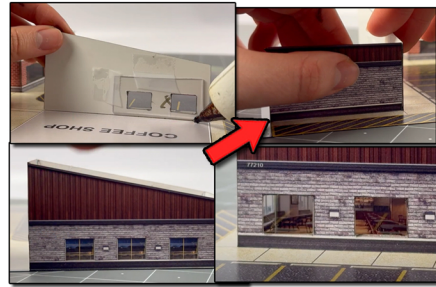

STEP 17- Afterwards, secure the coffee shop front wall on to the correct base. Once dry, grab the side walls and glue them on to the correct size. When dry, secure the back wall on to the rest of the building. Place the illusion room behind the open window sections. Secure using hot glue.

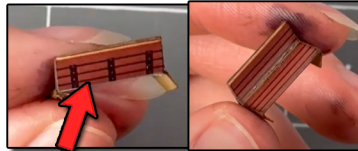

STEP 20- For the benches, grab the back bench walls and glue them evenly behind the top tab thats folded upwards. Use hot glue. Do this to however many benches you would like to use.



STEP 18- Now secure the coffee shop awning on to the right front corner like shown in the photo above. Use hot glue to secure.

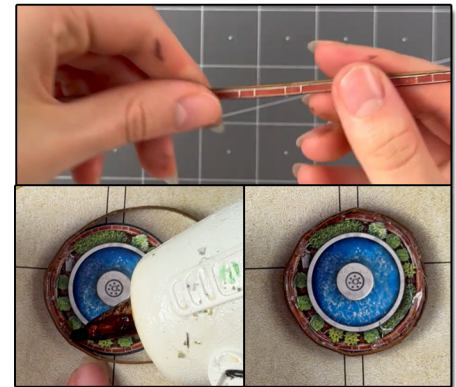

STEP 21- The last step, let's make the water fountain. Grab both water fountain walls and glue them on to the backs of each other evenly using hot glue. Slowly glue the wall around the original art. Place glue towards the inside. Once one small section is dried secure more around the art. Once done place landscape moss around the inside of the fountain to hide the glue, and to create bushes.



STEP 22- Once thats done, place the benches around the fountain how you would like! And we are done. Go to the other page to see the final results.

GO TO THE LAST PAGE TO SEE THE FINAL RESULTS



ASSEMBLY INSTRUCTIONS

Photo Real Scale Building Kit by

INNOVATIVE
HOBBY SUPPLY

**Convenience
Store and
Coffee Shop**



Front of Buildings



Rear of Buildings